

Tontit 32001/10, 32020/5 ja 6, mittakaava 1:2000

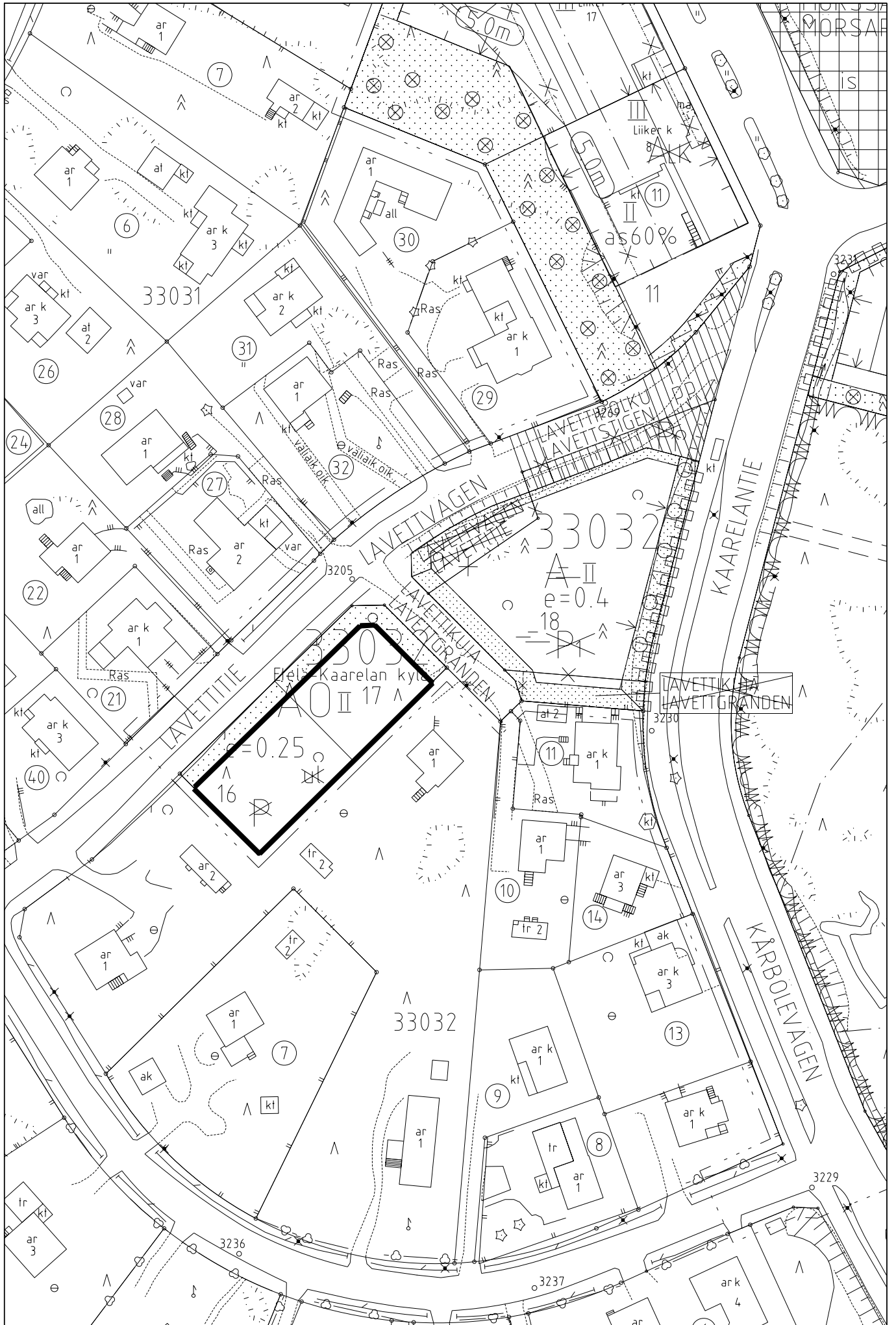

Tontit 33032/16 ja 17/Lavettitie, mittakaava 1:1000

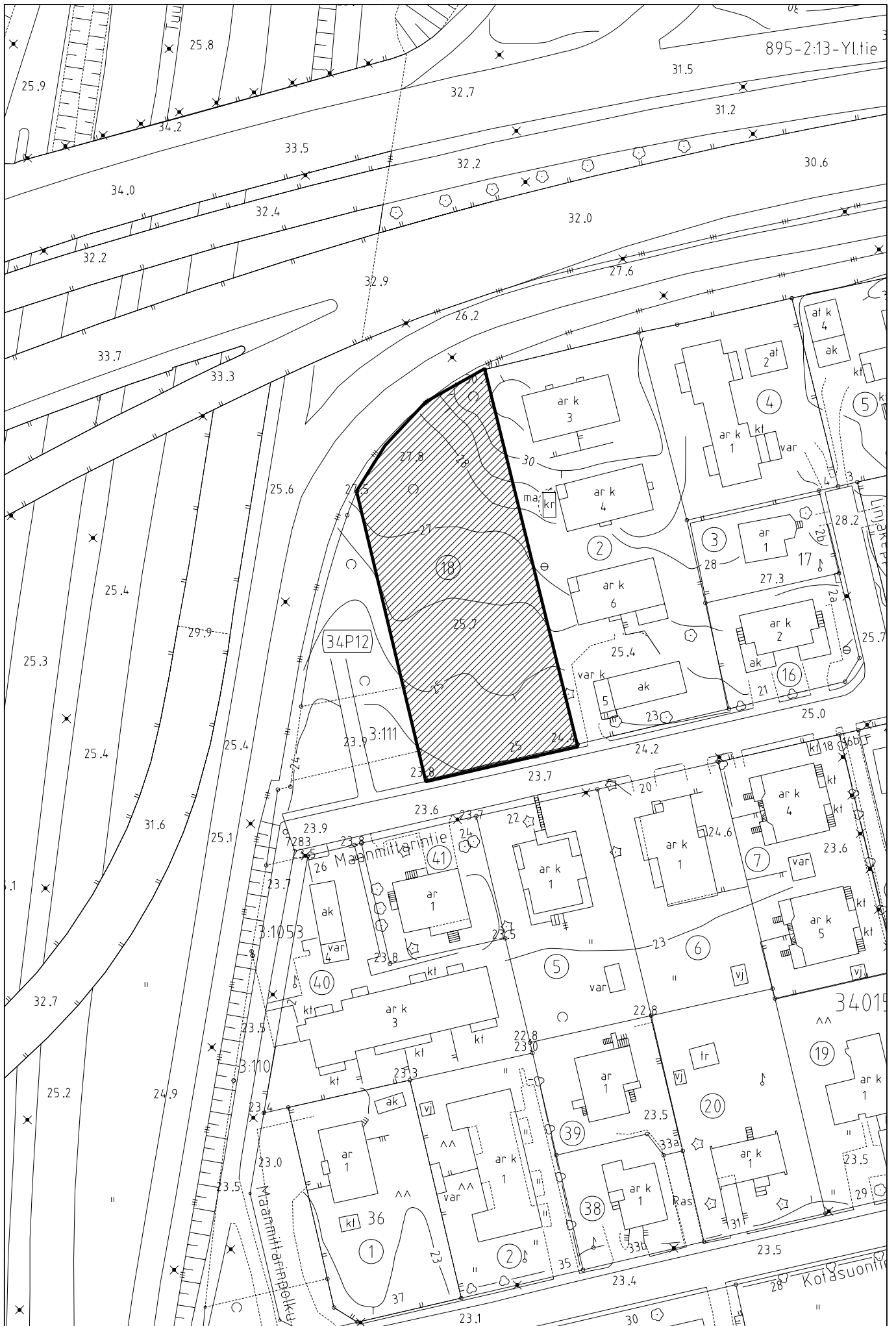

Pakila, tontti 34017/18, mittakaava 1:1000

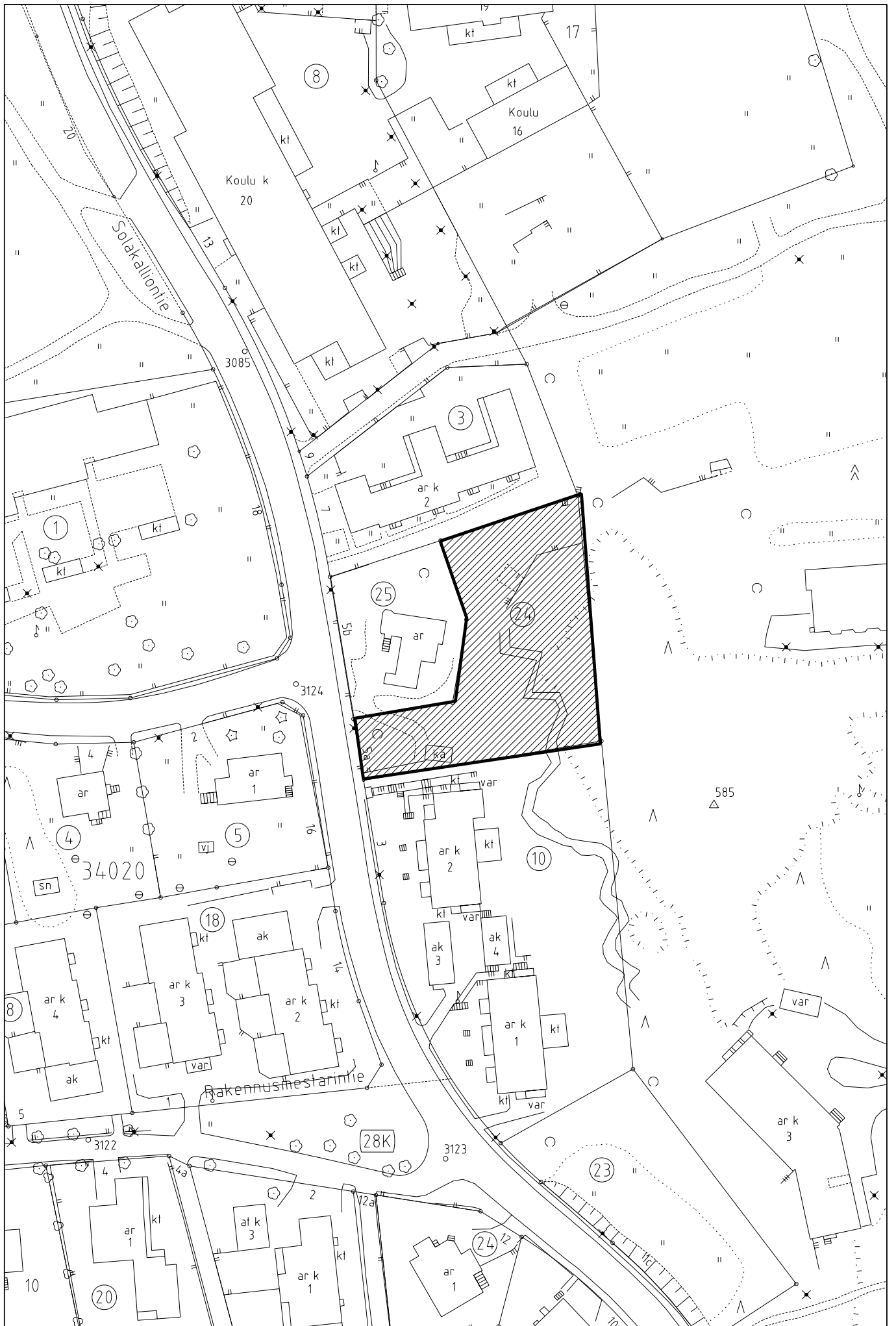

Pakila, tontti 34021/24, mittakaava 1:1000

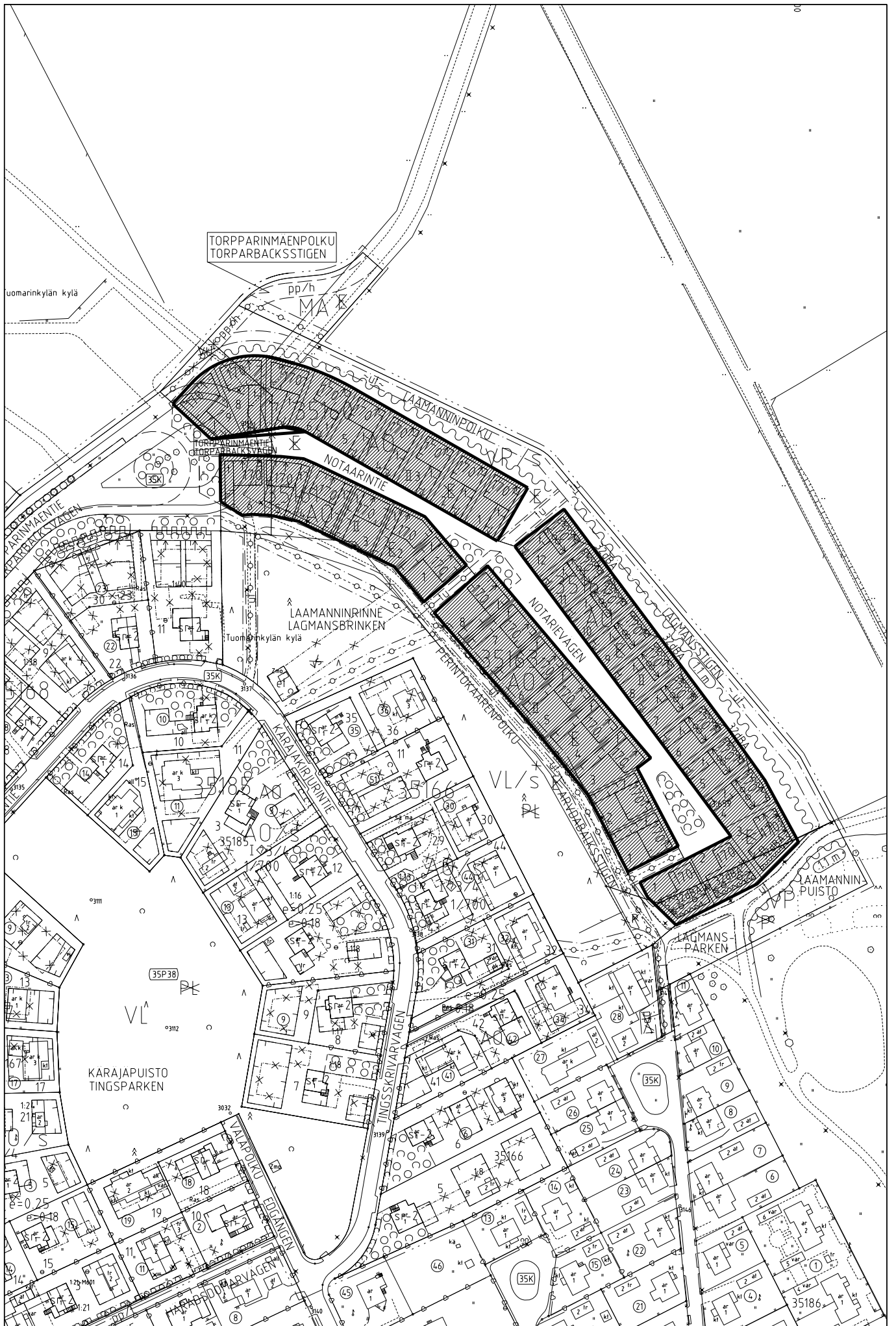

Tontit 35160/1-9, 35161/1-6, 35162/1-12 ja 35163/1-8, mittakaava 1:2000

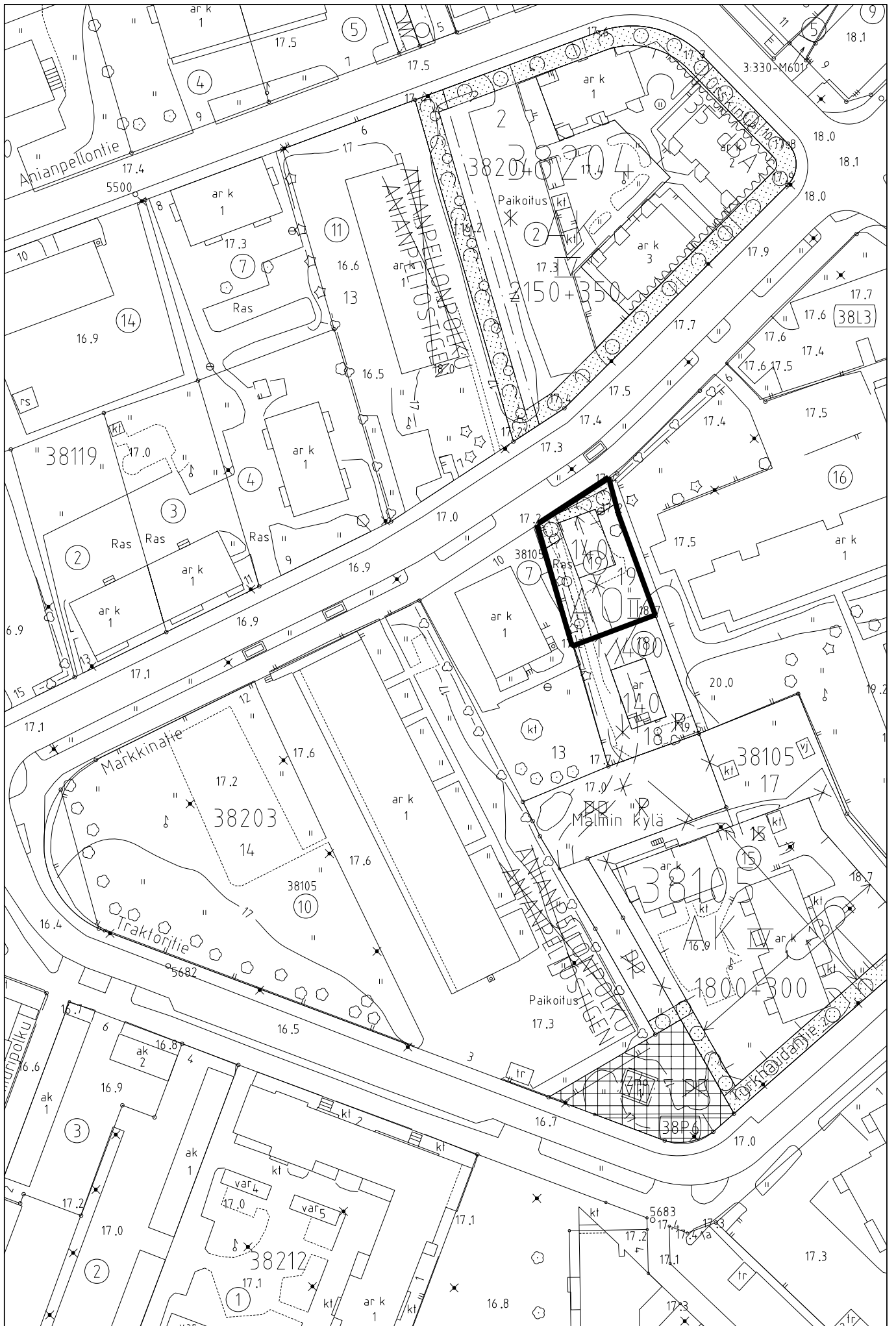

Tontti 38105/19, Markkinatie, mittakaava 1:1000

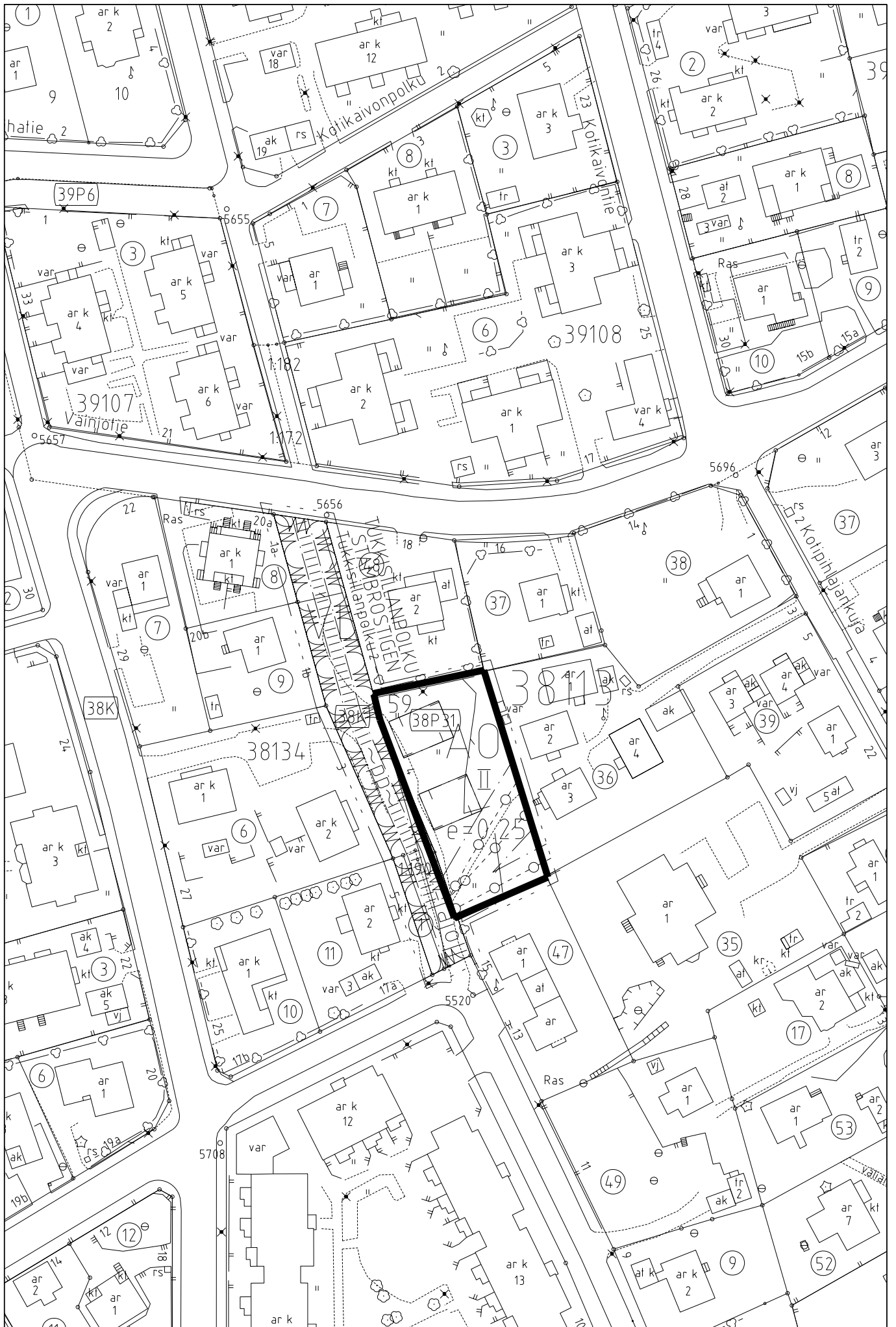

Tontti 38113/59, Malmi / Tukkisillanpolku 4, mittakaava 1:1000



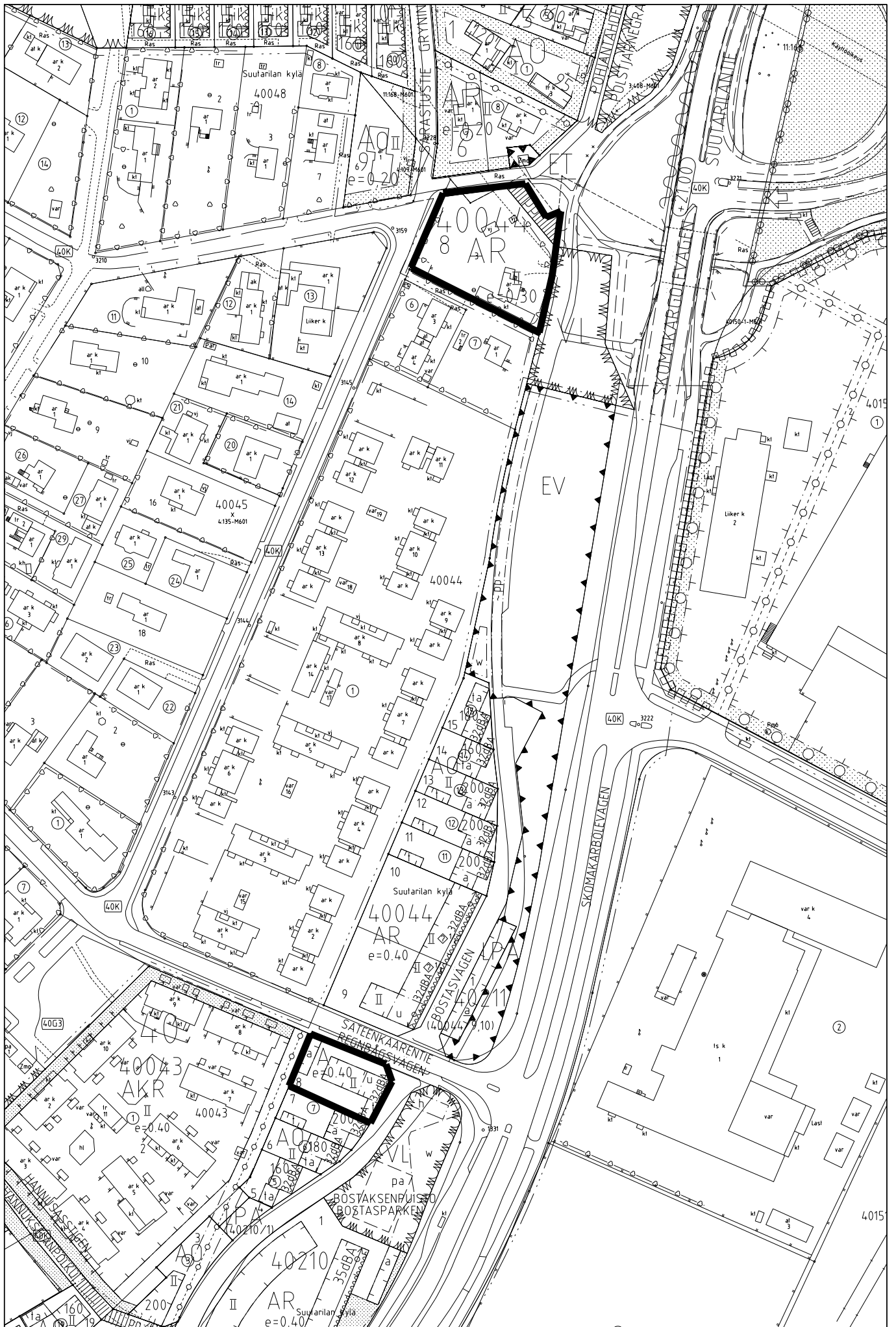

Suutarila, tontit 40043/8 ja 40044/8, mittakaava 1:2000





Tapanilan kylä

Suutarila, tontit 40099/3 ja 9, mittakaava 1:1000

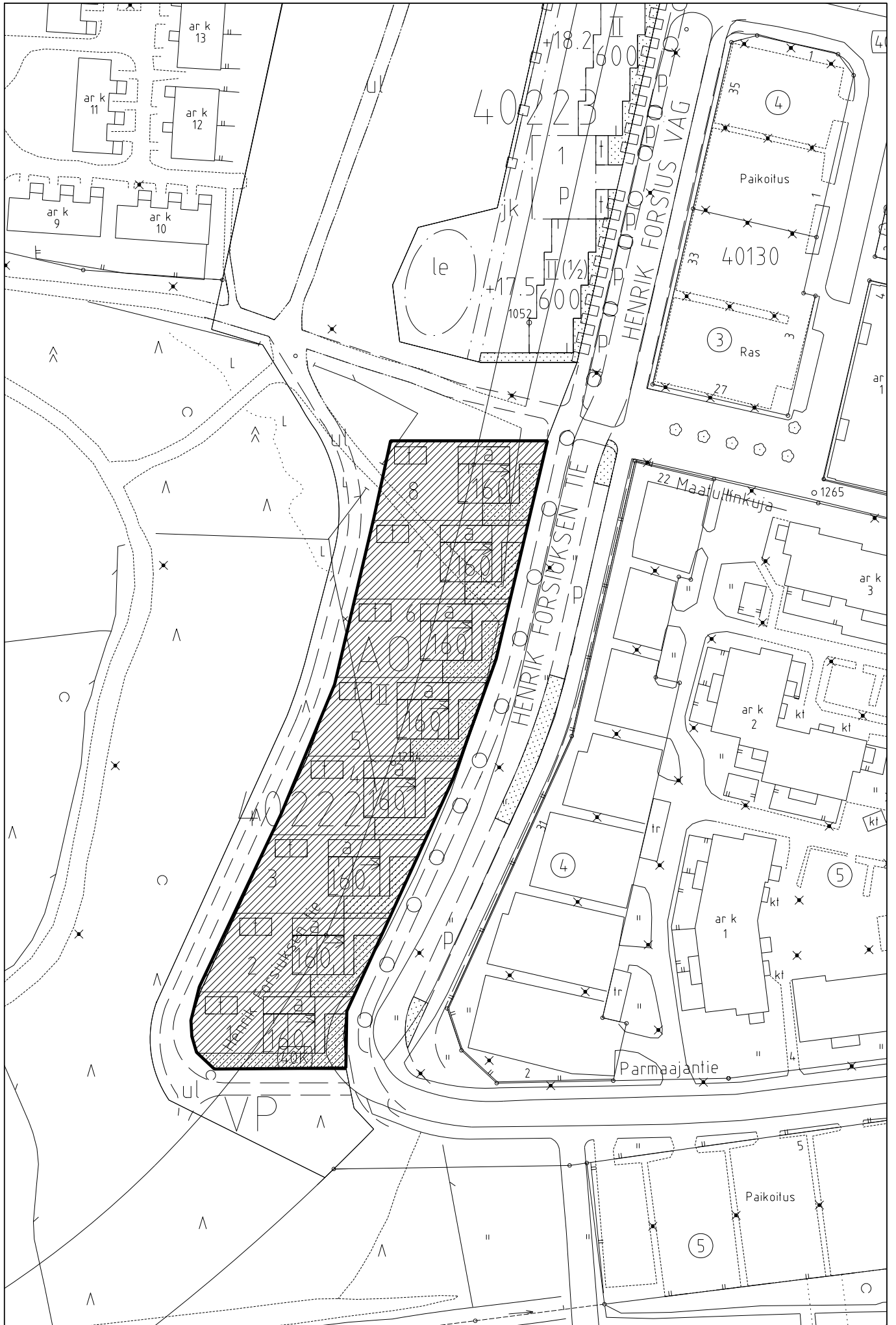

Tontit 40222/1-8, Henrik Forsiuksen tie, mittakaava 1:1000

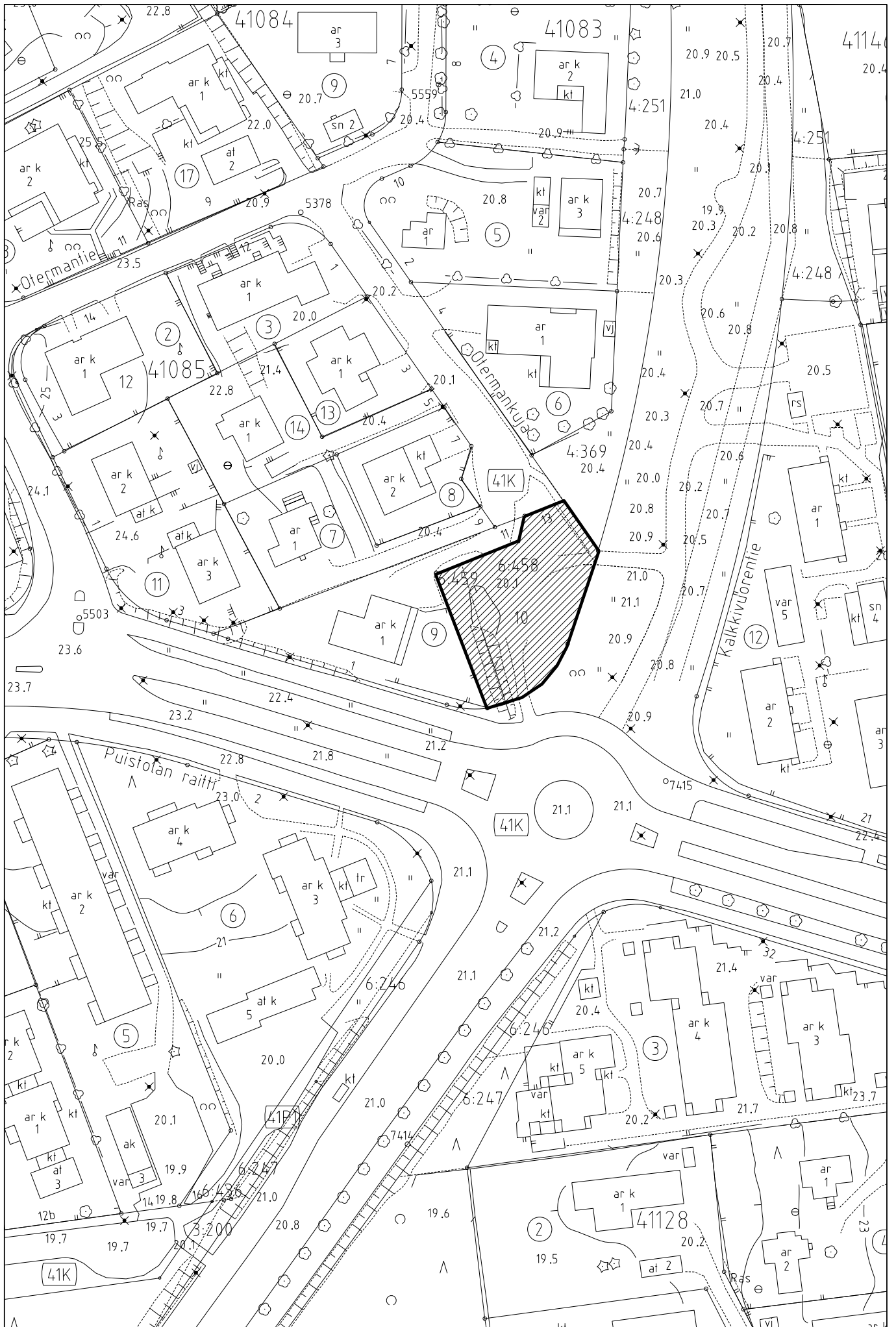

Tontti 41085/10, Otermankuja, mittakaava 1:000

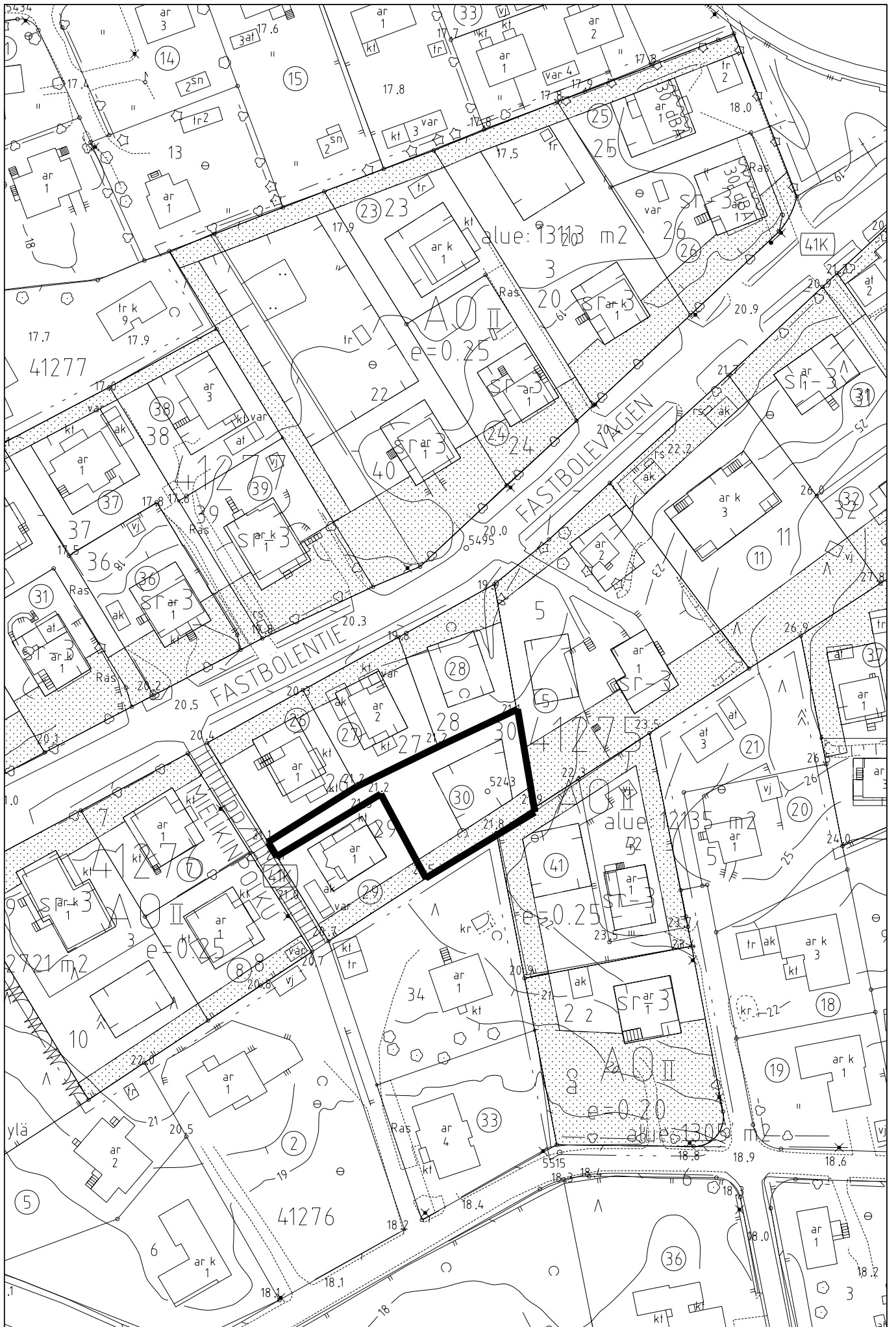

Tontti 41275/30, Mielikinpolku 5, mittakaava 1:1000

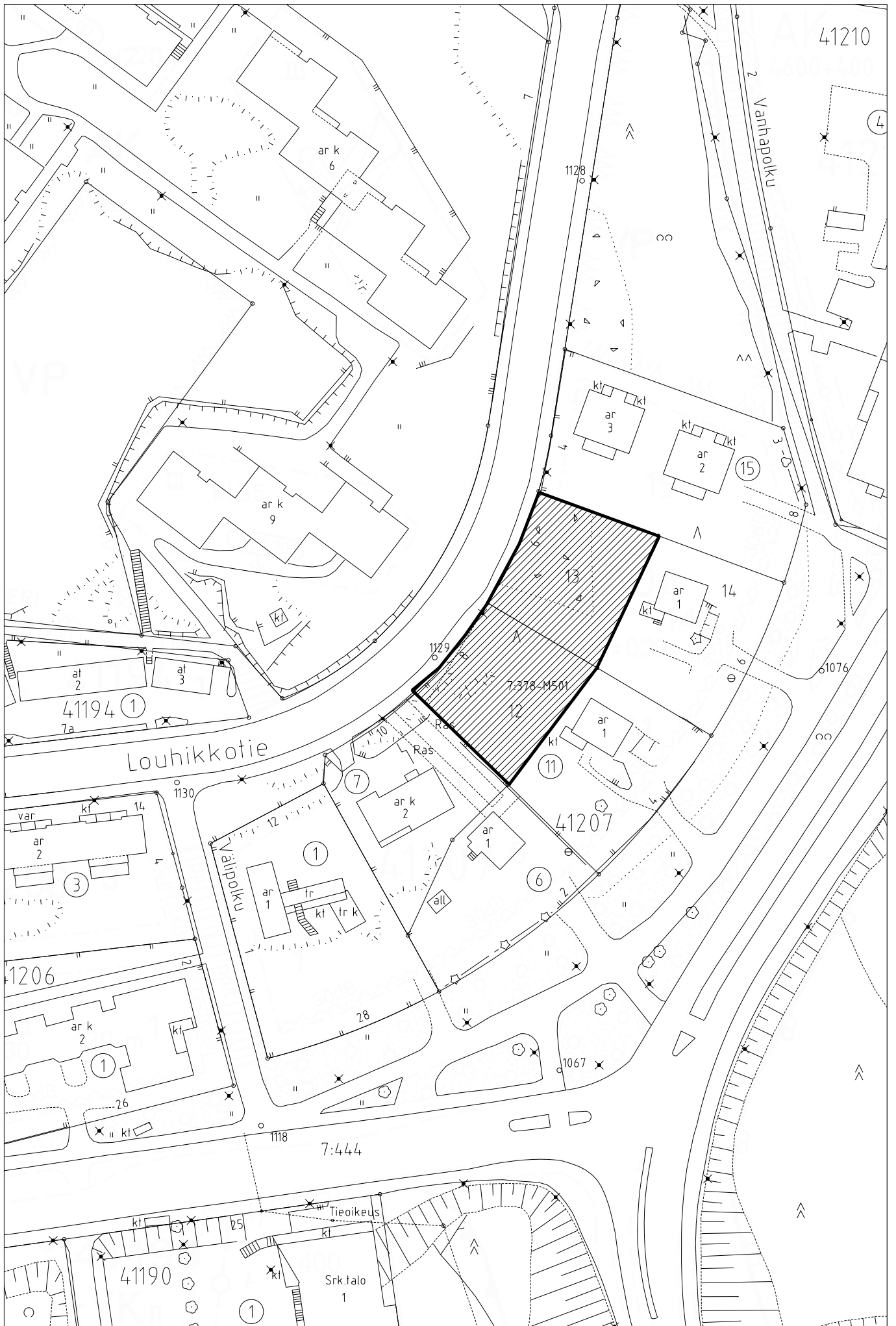

Jakomäki, tontit 41207/12 ja 13, mittakaava 1:1000

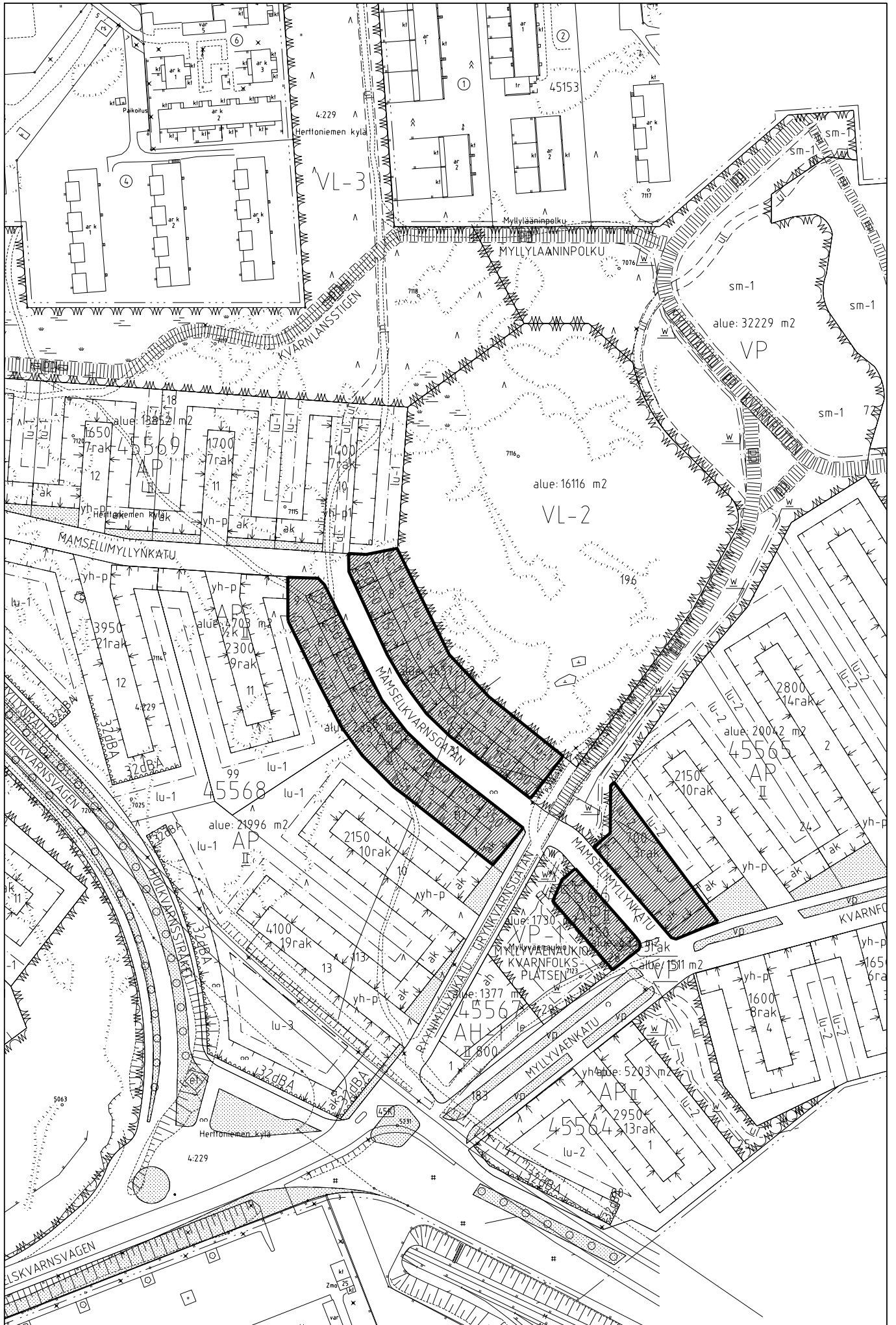

Tontit 45568/1-9, 45569/1-9, 45566/1 ja 45565/4, mittakaava 1:2000

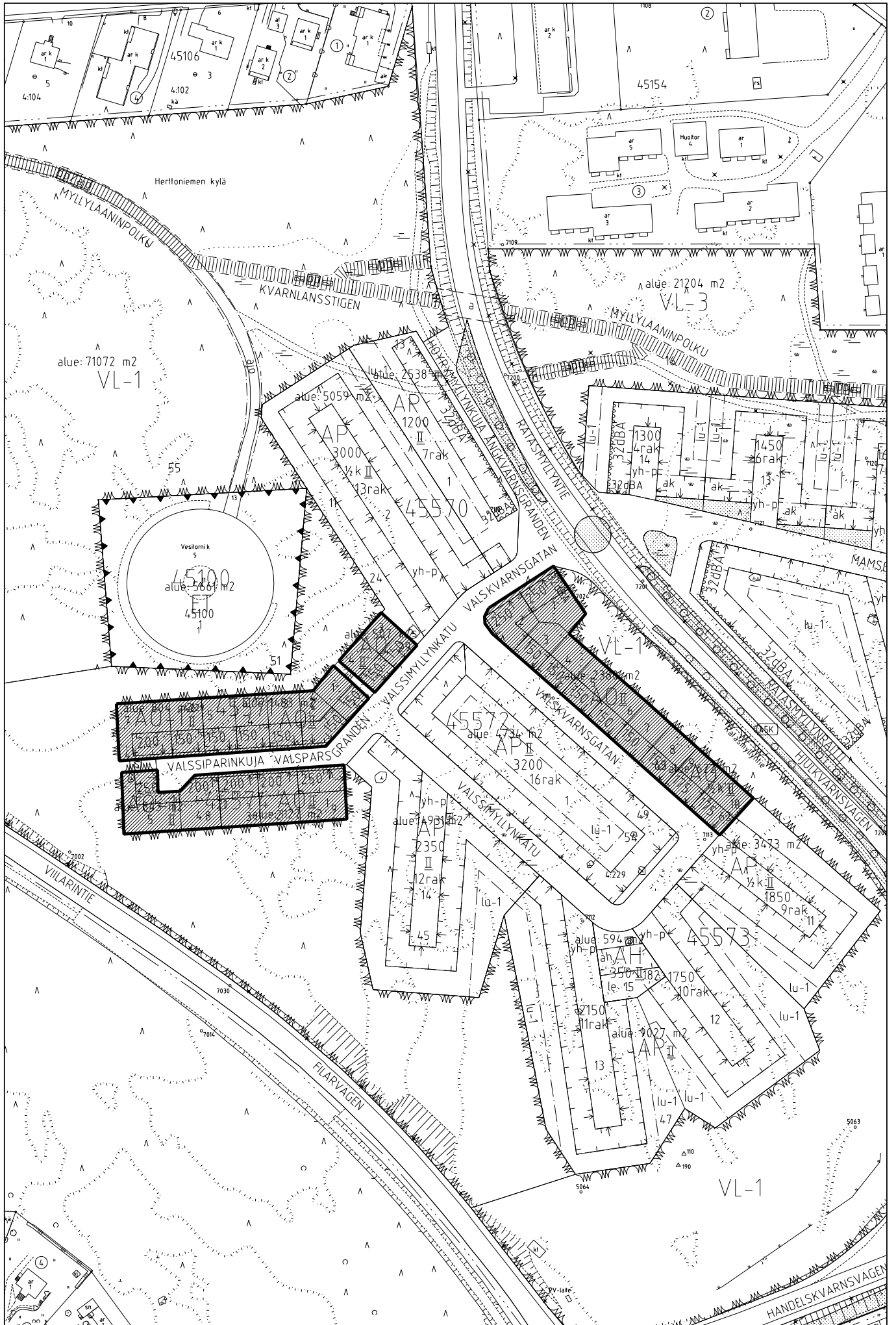

Tontit 45571/1-7, 45573/1-10, 45570/3 ja 4 ja 45574/1-5, mittakaava 1:2000



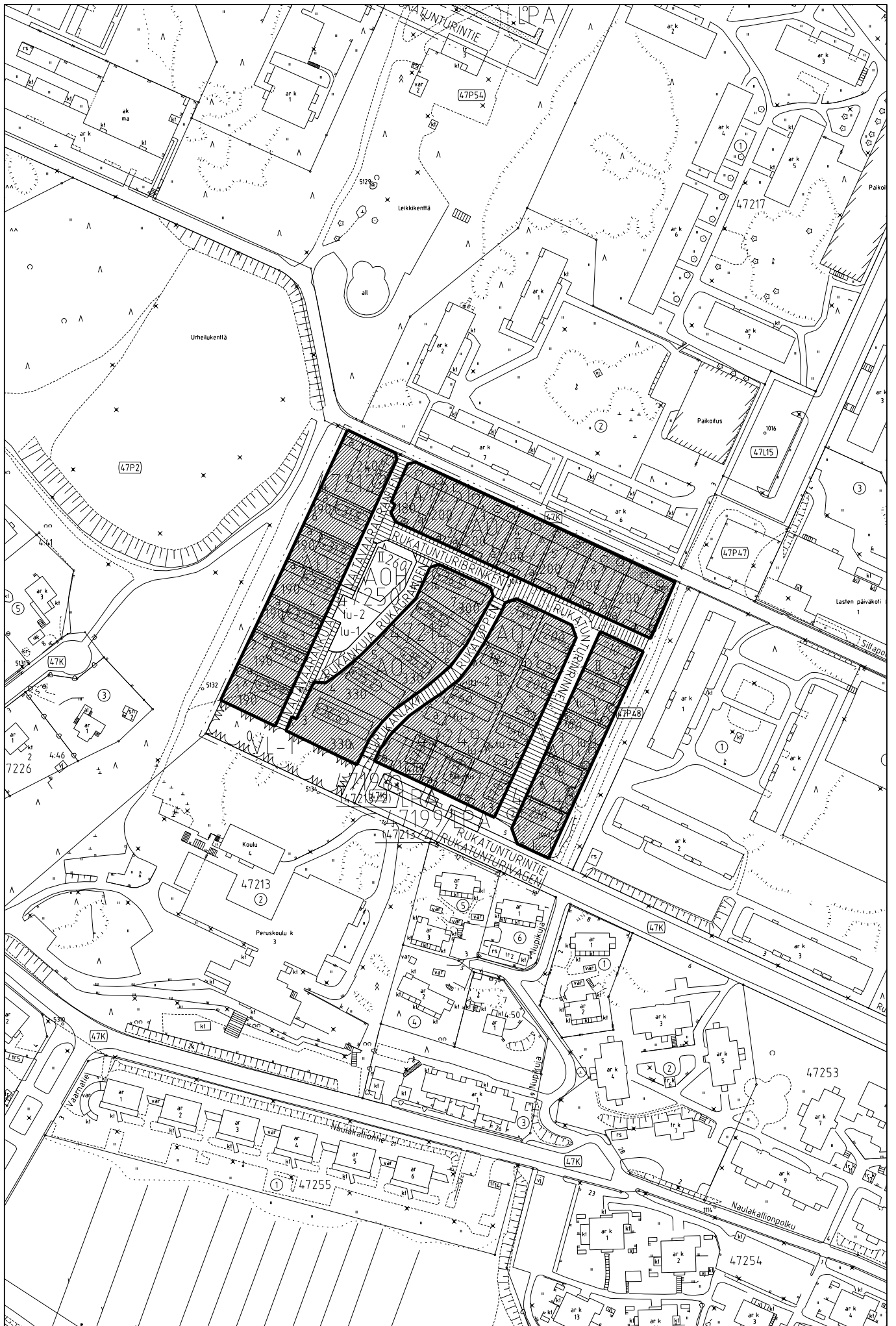

1:2000, tontit 47214/3-7, 47212/1-7, 47248/1-5, 47249/1-9 ja 47251/1-7

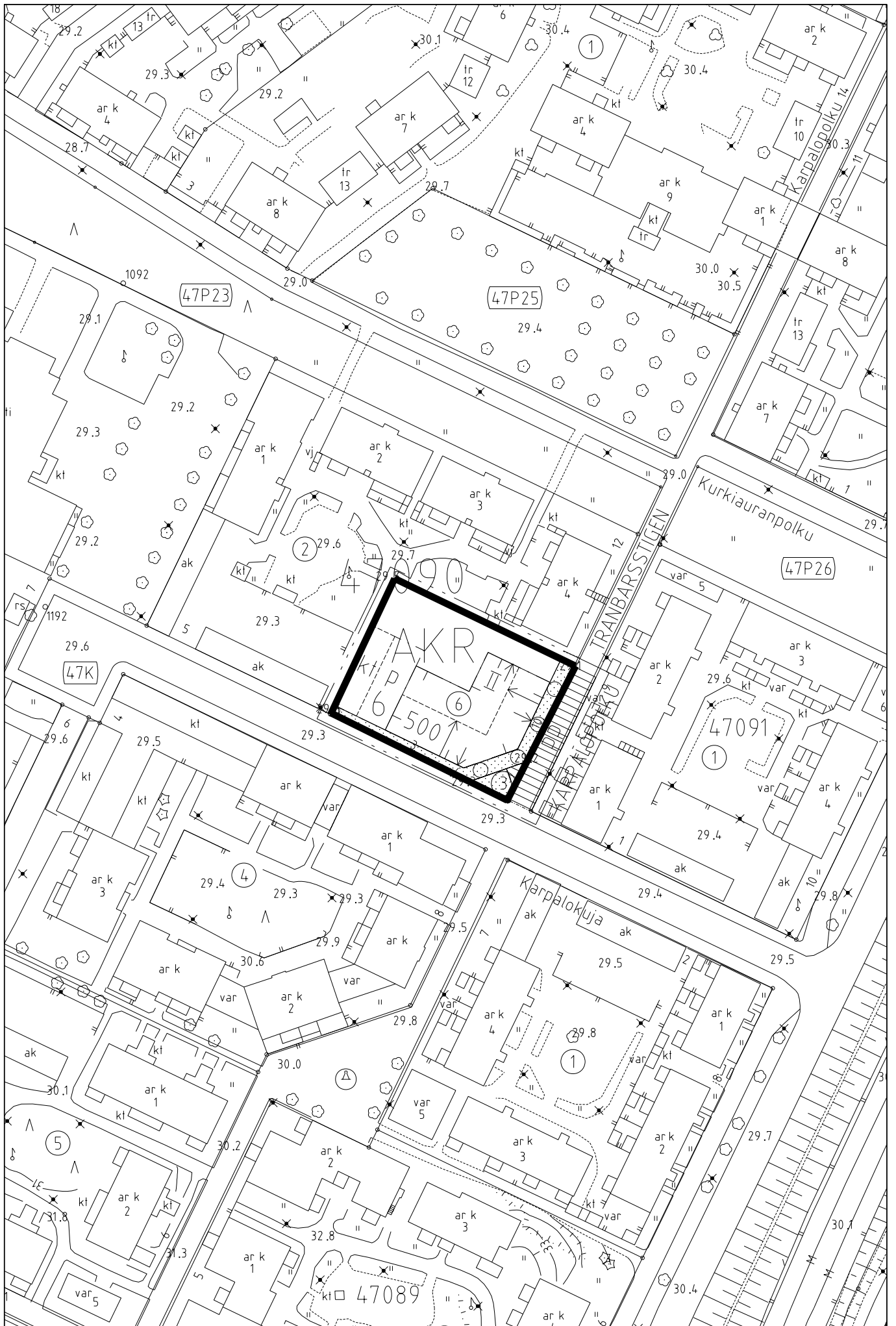

Kurkimäki, tontti 47090/6, mittakaava 1:1000

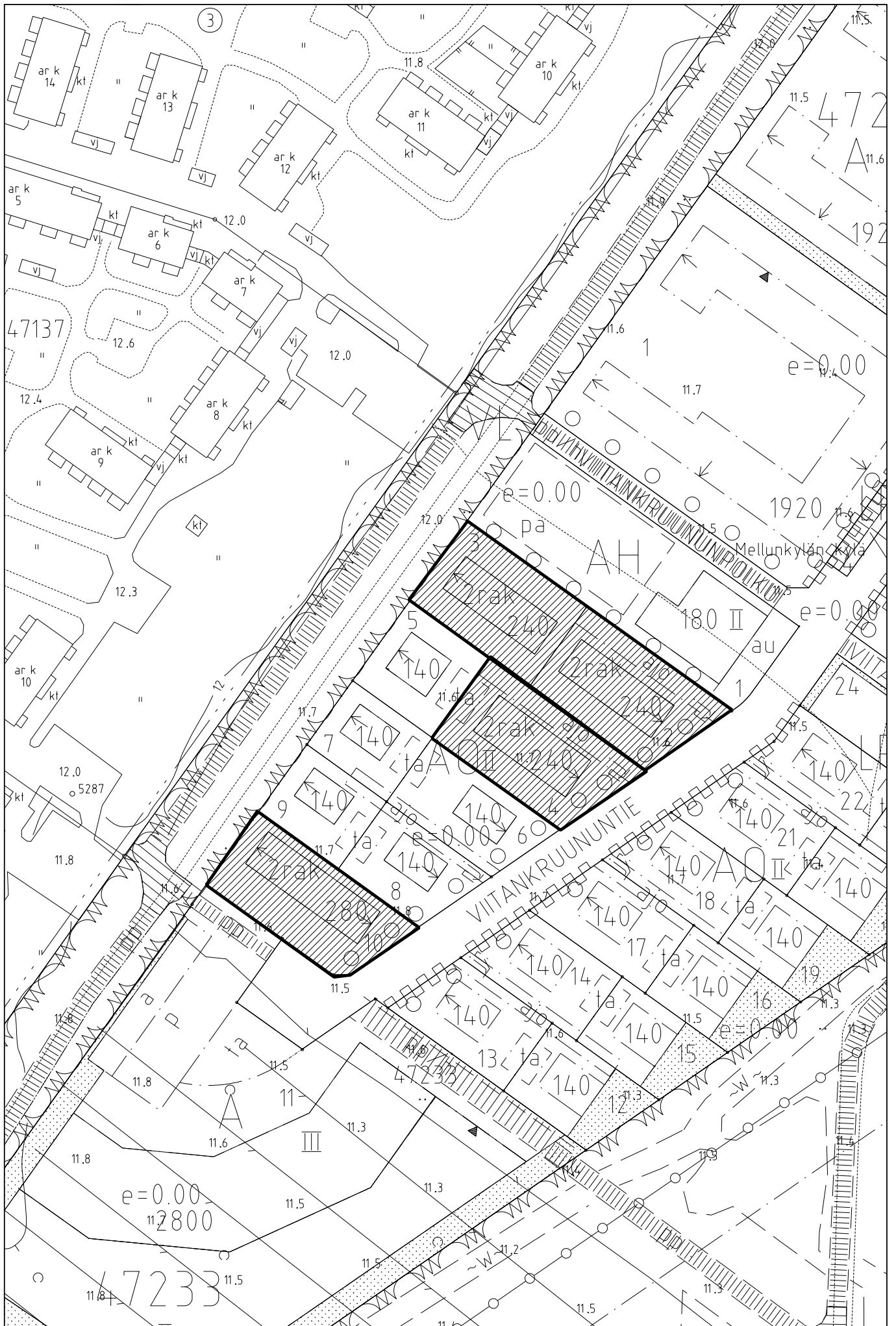

Vesala, tontit 47233/2, 3, 4 ja 10, Viitankruununtie, mittaakaava 1:1000

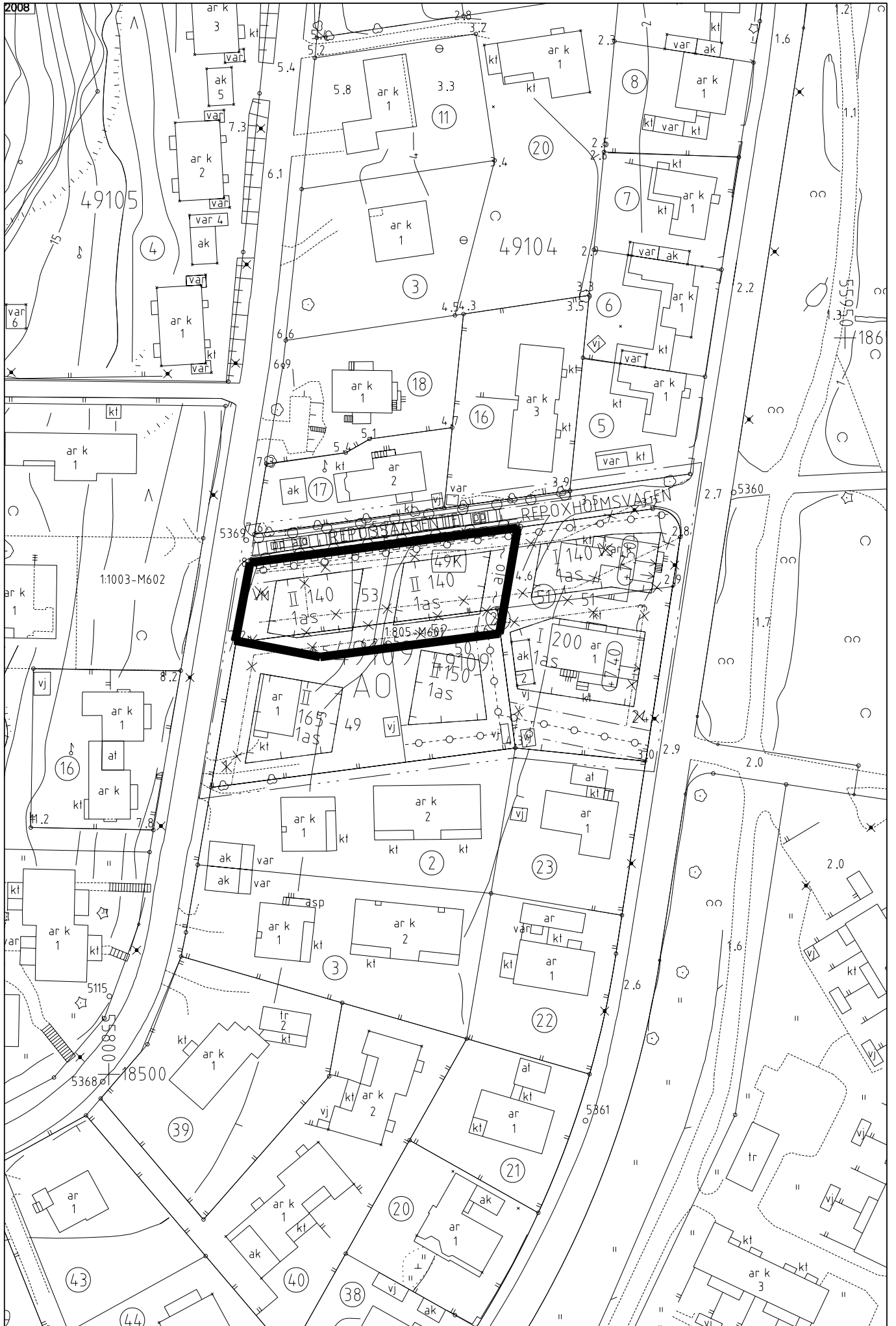

Tontit 49109/52 ja 53, Repossaarentie, mittakaava 1:1000